

Charging your device

Please charge your device for at least 1 hour before using

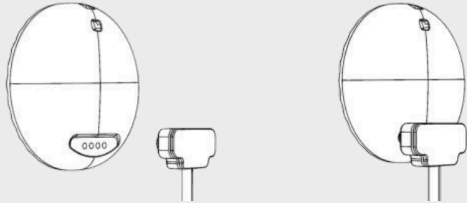

- When placing magnetic USB cable to device charging contacts make sure it is positioned correctly.
- The LED should blink when charging and solid when fully charged.
- When the battery level falls below 20% it will send low battery warning message to all contacts via text message.

Switch ON device

To turn the device on-press the SOS button for 2 to 5 seconds. The LED will flash rapidly for a few seconds and then stop (save power). The device can also be switched on automatically by charging the battery.

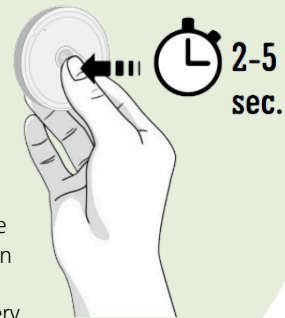

Activating SOS alarm

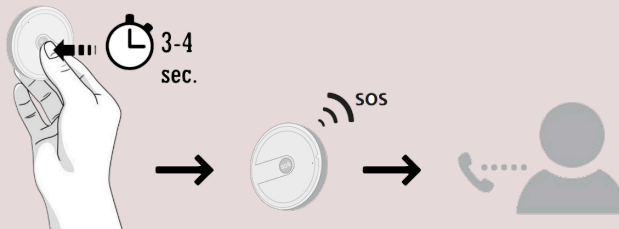

- When you need help, press the SOS button for 3-4 seconds until you hear a voice prompt of activating an SOS alarm.
- This starts the sequence of help message followed by the outgoing help calls.

Turn OFF device



The device can be turned off only through the configuration tool.

TIP

We strongly recommend to turn off the LED to save power (short press SOS button to turn off LED).

Reboot the device

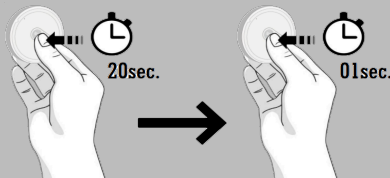

To restart the device, press the SOS button for 20 seconds then stop, then press briefly for 1 second.

Contact and Support

For technical or operational questions please feel free to contact us

24/7 support

Email: support@satmars.de
Tel.: +49 (0) 2131 772 397 022

Return address for repairs or returns

SatMARS Navigations- u. Kommunikationssysteme GmbH
Bussardweg 14
D-41468 Neuss

Invoicing

Email: invoicing@satmars.de
Tel.: +49 (0) 2131 772 397 00

